

BUILD AN OLYMPIC GAMES TORCH

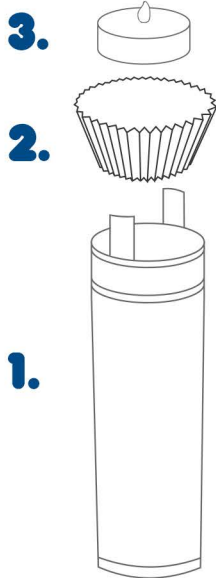

INSTRUCTIONS

1. Cut out the torch handle and roll it into shape. Glue or tape to secure.
2. Cut two slits in the bottom of a muffin liner. Slide the tabs through the slits and secure.
3. Add tissue paper flames and a battery-operated tea light.
4. Carry your torch proudly!

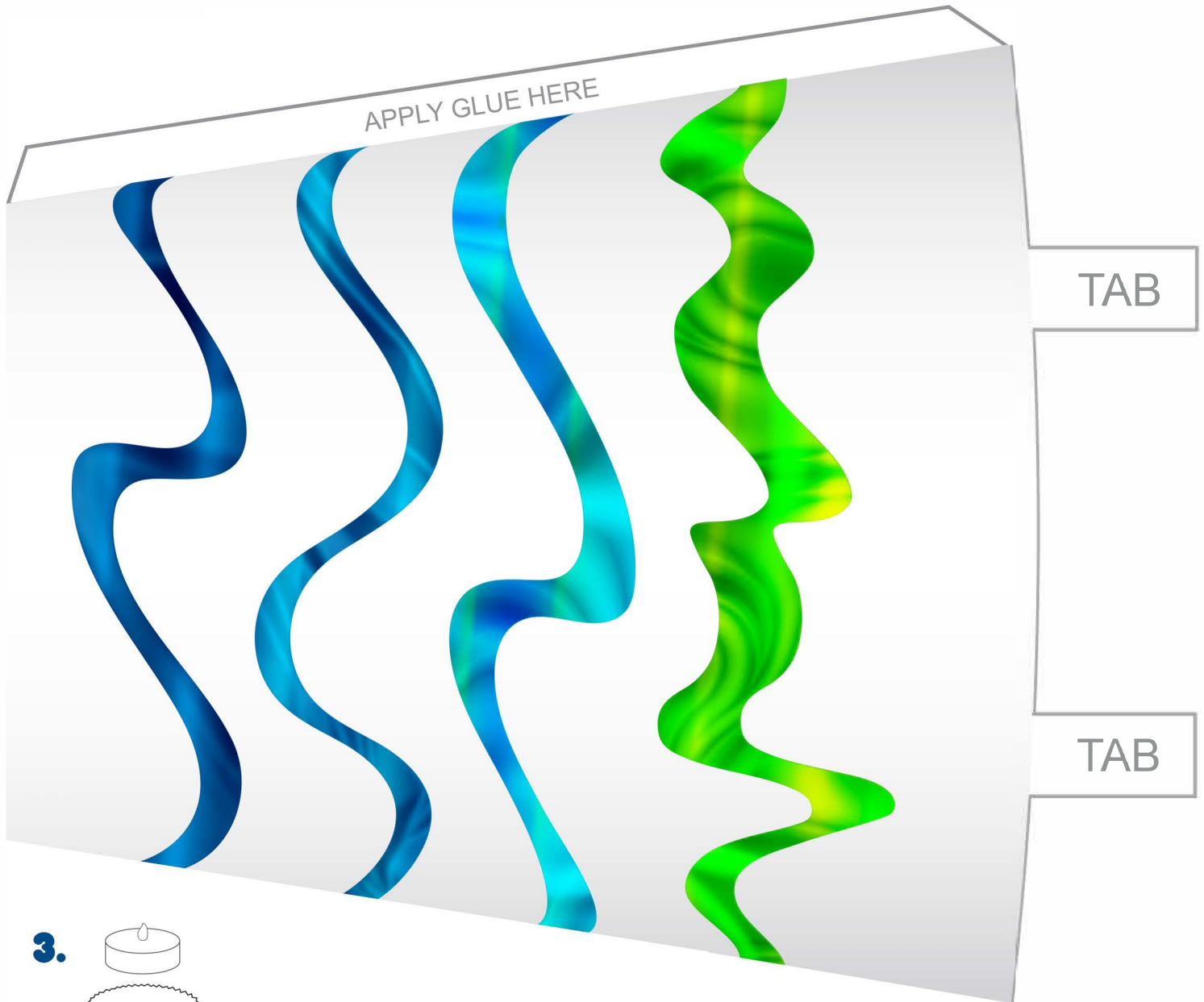